

PLEASE DO NOT MODIFY OR DUPLICATE WITHOUT PRIOR PERMISSION FROM HEADWAY TRAFFIC MANAGEMENT

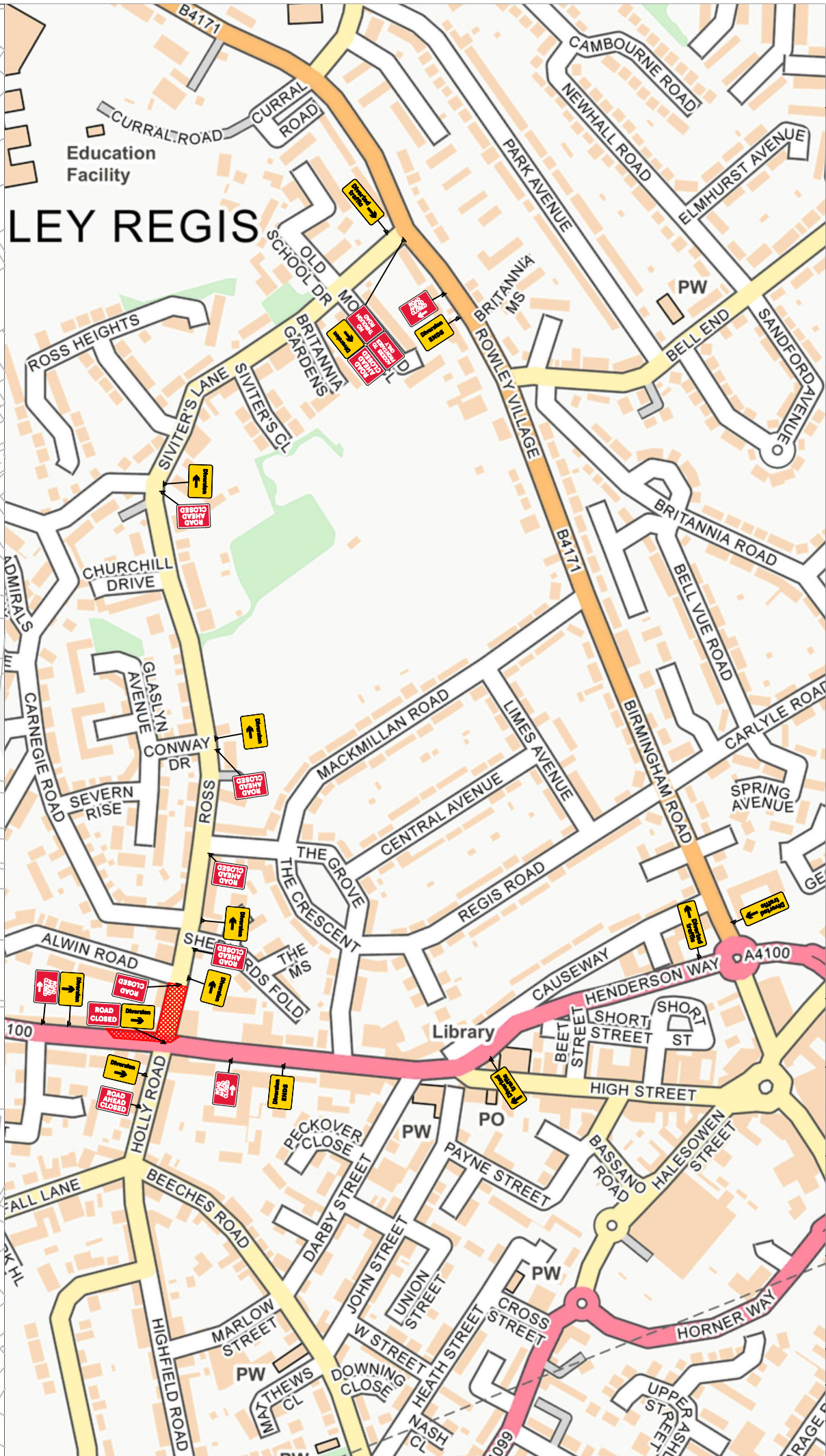
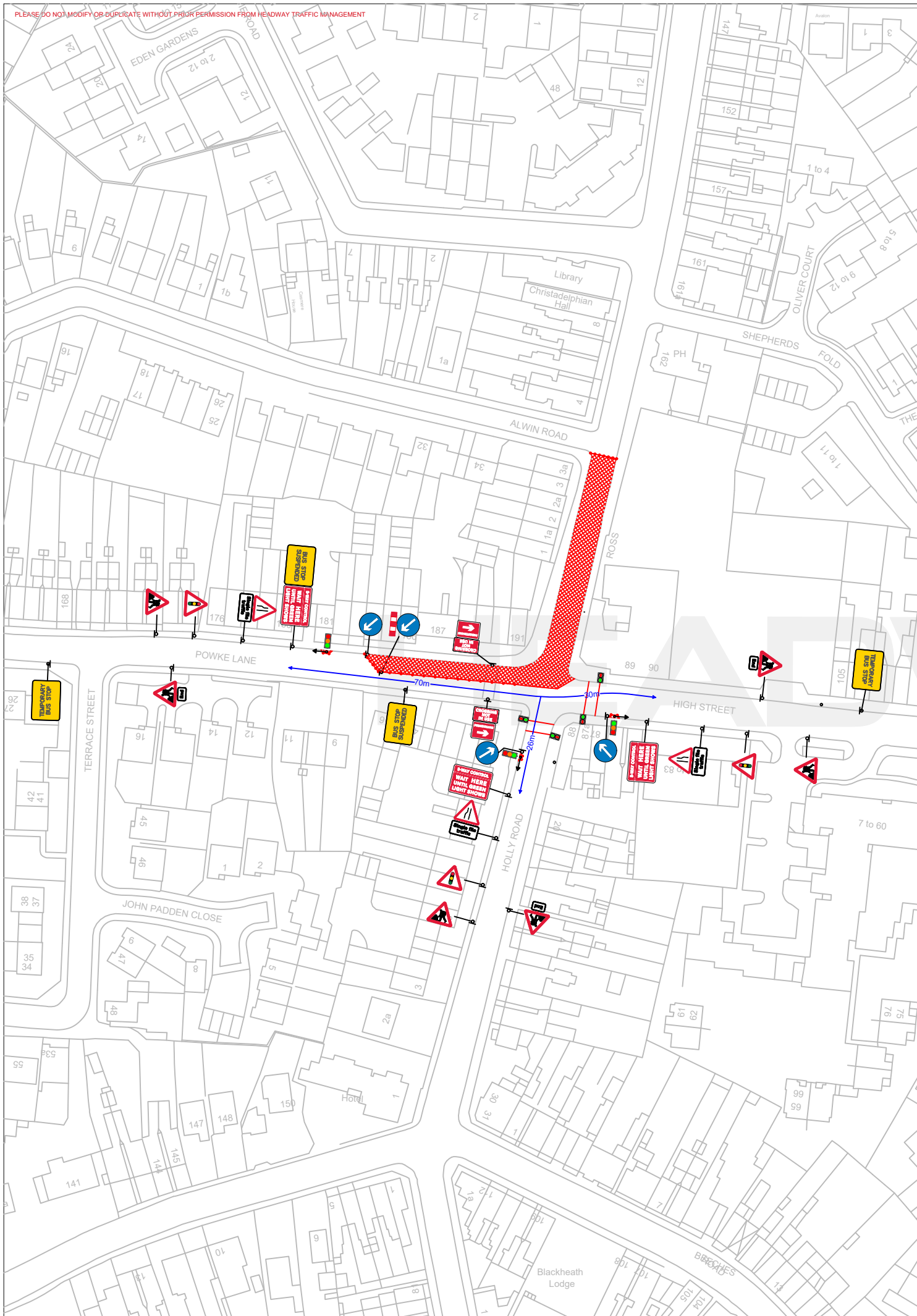

NOTES:
 ALL TRAFFIC MANAGEMENT TO BE IN ACCORDANCE WITH 'SAFETY AT STREETWORKS & ROADWORKS' AND THE TSRGD 2016. AND INSTALLATION, MAINTENANCE AND DISMANTLE METHODS MUST COMPLY WITH HEADWAY TRAFFIC MANAGEMENT'S RELEVANT METHOD STATEMENT(S).

- P1** 40 Seconds Green
15 Seconds Red
- P2** 40 Seconds Green
15 Seconds Red
- P3** 40 Seconds Green
15 Seconds Red

Additional Signage



Cadent to supply and install footway/footpath closure signage accordingly before works can commence.

HEADWAY
 TRAFFIC MANAGEMENT

Cadent
 Your Gas Network

PROJECT:
 3 Way Lights &
 2 Ped Crossings With
 Road Closure Diversion

SITE ADDRESS:
 187-191 High Street,
 Rowley Regis,
 B65 0AA

DRAWN BY: G.Arundel
DATE: 04/12/2024

CHECKED BY: C.Moran
OUR REF:

REF:
REVISION: