

- NOTES:**
1. All signs and cones to be in accordance with Chapter 8 new roads and street works a code of practice (Red book)
 2. Works access and egress are indicative, exact locations to be agreed on site.
 3. Safety zones are to be installed as required as shown by the SAFETY ZONE DIMENSIONS BELOW
 4. All signs to be located so as not to obscure signs or objects and should be ballasted near to ground level using sand filled hessian bags or sign straps.
 5. All sign positions are indicative only and must be accurately positioned on site with good visibility and be clear of and obstructions or vegetation at all times.
 6. Drawing not to scale

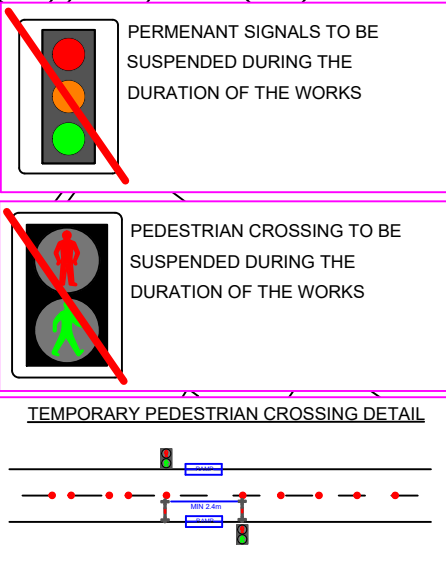
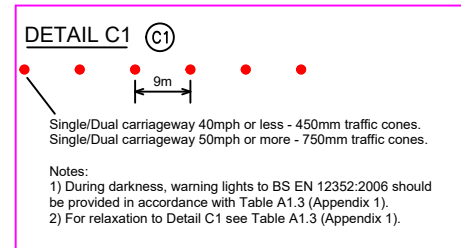
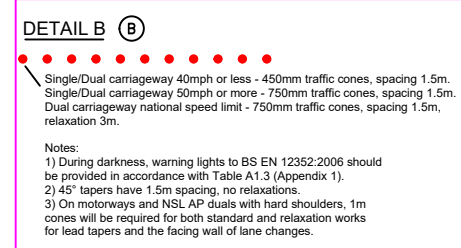
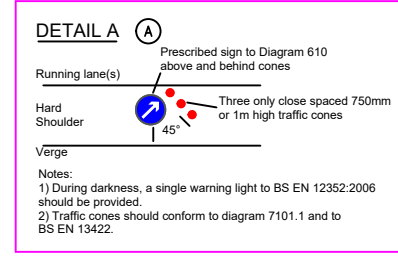

- NOTES:**
- Traffic sign
 - Cone
 - Work Area
 - Safety Zone
 - Diversion
 - Diversion
 - WORKS ACCESS
 - WORKS EXIT
- Works access/ works exit to be risk assessed on site for suitability of location

- TRAFFIC MANAGEMENT NOTES**
- MULTI - PHASE TRAFFIC SIGNALS :**
- NOTES**
- 1 All traffic signs shall comply with Chapter 8 of the Traffic Signs Manual
 - 2 Maximum distance between any two temporary traffic signals to be 240m. Minimum distance between any two temporary traffic signals to be 30m.
 - 3 Temporary traffic signals shall not occur within 150m of an existing level crossing, Pelican crossing or signalised junction without the consent of the Engineer. The Engineer shall consult with the authority responsible for any of these types of facility prior to traffic management being installed in adjacent areas.
 - 4 Coning shall be installed at 45° to the edge of carriageway, as generally indicated.
 - 5 Multi-phase portable traffic signals shall operate in vehicle actuated (VA) mode at all times unless otherwise directed by the Engineer.
 - 6 Multi-phase portable traffic signals shall only be installed with the written permission of the local highway authority whose roads they are installed on.
 - 7 Cable crossing protectors and P7010/P7013 signs shall be provided whenever control cables cross a section of carriageway open to traffic.
 - 8 The signal control mechanism shall normally be placed in a location from which it is possible to view all approaches to the site.
 - 9 Duplicate primary signal to be installed as instructed.
 - 10 Lane width past the works to be 3.7m maximum, 3.25m desirable minimum, 3.0m absolute minimum.

SPEED OF ROAD:

LONGWAYS:	0.5m	
SIDEWAYS:	0.5m	

A	35	A	10
B	35	B	10
C	35	C	10
D	35	D	10

CLIENT:

Cadent
Your Gas Network

SITE:
10 High St, Princes End, Tipton DY4 9HW

GRID REF: -----

TITLE: FOUR WAY TEMPORARY TRAFFIC SIGNALS

SCALE AT 13: NTS	DATE:	DRAWN: JB	CHECKED: LS
DWG NO: WMGA240303	REV NO:	001	

Qty: 1 Ref: 13-9 Schedule 13 - Temporary Sign		Qty: 2 Ref: 610 Keep left	
Qty: 2 Ref: 2702 Start of temporary diversion route		Qty: 1 Ref: 612 No right turn	
Qty: 2 Ref: 2702 End of temporary diversion route		Qty: 1 Ref: 613 No left turn	
Qty: 4 Ref: 2702 Start of temporary diversion route		Qty: 3 Ref: 645 End panel	
Qty: 1 Ref: 2703 Direction of temporary diversion route from junction ahead		Qty: 7 Ref: 7011 Road works ahead	
Qty: 1 Ref: 2703 Direction of temporary diversion route from junction ahead		Qty: 2 Ref: 7010.1 Nature of temporary hazard ahead - Road Closed	
Qty: 2 Ref: 517 Road narrows on one side only ahead - right		Qty: 7 Ref: 7010.1 Nature of temporary hazard ahead - Road Ahead Closed	
Qty: 2 Ref: 517 Road narrows on one side only ahead - left		Qty: 3 Ref: 7011.1 3 Way Control - Wait here until green light shows	
Qty: 3 Ref: 518 Single file traffic		Qty: 2 Ref: 7105 Lane closure barrier	
Qty: 3 Ref: 543 Traffic signals ahead			
Qty: 1 Ref: 610 Keep left			